

# TAFE NSW South Western Sydney Institute

Lidcombe College

PO Box 142  
Regents Park NSW 2143  
Australia  
Phone: 02 9643 4501  
Fax: 02 9643 4699  
Email: lidcombecio@tafensw.edu.au  
Web: www.swsi.tafensw.edu.au

South Western Sydney Institute comprises nine colleges. Four offer Arts & Design courses.

Application dates:

Semester 1: 6th August 2007 to 26th October 2007

Semester dates:

Semester 1 2008: 11th February 2008

Open day:

27th November 2007 6pm until 9pm - All welcome  
Exhibition open Wednesday 28th November 2007 to  
Tuesday 4th December 2007 9am to 5pm.

## PROGRAMS/COURSES

### **Industrial Design**

Product Design  
Furniture Design

### **Architecture**

Interior Design  
Interior Decoration

### **Design**

Design  
Design Fundamentals

# TAFE NSW South Western Sydney Institute

Lidcome College

## Industrial Design

Product Design  
Furniture Design  
[www.swsi.tafensw.edu.au](http://www.swsi.tafensw.edu.au)

### SUBJECTS

Product Design  
Furniture Design

### AWARDS

Advanced Diploma in Product Design & Development  
2 years full time  
[www.swsi.tafensw.edu.au](http://www.swsi.tafensw.edu.au)

Product Design and Development is for people who want to work as professional product designers and developers. You will acquire a sound knowledge of technologies and materials in conjunction with creative thinking; analytical and problem-solving skills that underpin successful design solutions. You will learn to identify, design and develop new and innovative products for a broad range of markets and functions, including consumer products, furniture, lighting and industrial products. You will explore the relationship between objects and aesthetics, people and products and how they are used both in functional, cultural and social contexts. In particular, you will investigate responsible and innovative use of design, technologies, resources, materials utilisation and material re-use. The Product Design and Development course provides both the theoretical and practical aspects of product design and draws from a broad range of disciplines, all located on campus. This enables students to interact with other sections such as Furniture Trades, Polymers, Electronics and CAD Technologies.

## Diploma in Furniture Design

2 years full time

[www.swsi.tafensw.edu.au](http://www.swsi.tafensw.edu.au)

Furniture Design provides comprehensive training in the creative and practical production skills required by those considering a career in the production of contemporary furniture design. You study new technologies, including new materials and studio design practices, with an emphasis on workshop methods, computer applications, marketing and business studies, and individually creative and innovative expression, including the use of computer-aided design and modeling. During the course you will be encouraged to develop a thorough awareness of the various technical and creative aspects of working as a designer with a focus on domestic, commercial, corporate and customised furniture products. You will also develop individual craftwork for sale through gallery exhibition. Furniture Design course at Lidcombe is linked closely to the State Centre of Furniture Trades. Well equipped workshop facilities are used to construct prototypes with an emphasis on health and safety awareness. The course offers a balance of design and production with students being encouraged to

explore and expand their design ideas. A mix of fundamental skills and new 3D computer software allows students to visualise and communicate their ideas fully.

## Architecture

Interior Design  
Interior Decoration  
[www.swsi.tafensw.edu.au](http://www.swsi.tafensw.edu.au)

### SUBJECTS

Interior Design  
Interior Decoration  
Colour & Design

### AWARDS

Advanced Diploma in Interior Design  
3 years full time  
[www.swsi.tafensw.edu.au](http://www.swsi.tafensw.edu.au)

Interior Design instructs you in the theoretical and practical aspects of interior design. It is for people who want to enter the industry in a freelance capacity or as the owner/manager of a small business or as a designer/manager in a design practice. You will learn how to solve problems creatively, be imaginative, think laterally and extend and transform problems by designing innovative solutions; encourage and promote creativity both for yourself, your colleagues and contacts; produce creative contemporary designs taking into account historical, socio-economic, political and environmental influences; and produce creative design solutions encompassed by the practice of interior design.

The course shows you how to work productively with others, respond to changing circumstances, clarify ideas, communicate them clearly and ensure that the vision is shared and understood the same way by all involved; use effective interpersonal skills to communicate with design team members, clients, associated professionals, suppliers and service providers; and communicate design intentions using a range of techniques, media and technologies. You will also learn about business planning, project and financial management skills in the development of a design project; how to use effective leadership skills to manage others, allocate work and provide support and feedback; and how to manage your own professional development, time management skills and performance in the workplace. You will learn how to stay abreast of trends, fashions and technical developments in the design area; develop and maintain knowledge of sources of related products, suppliers, contractors and specialist expertise required to support a design proposal; and apply knowledge of manufacturing, construction and fabrication processes in the development of a design project.

# TAFE NSW South Western Sydney Institute

Lidcome College

Diploma in Interior Decoration  
2 years full time/part time equivalent  
[www.swsi.tafensw.edu.au](http://www.swsi.tafensw.edu.au)

Interior Decoration aims to provide students with the skills, knowledge and attitudes required to provide interior decoration solutions taking into consideration aesthetics, function, marketing, manufacturing, marketability and selection of products, materials and environments for the benefit of the user. It also aims to provide vocational training in the theoretical and practical aspects of Interior Decoration for learners who wish to enter the industry in a freelance capacity as the owner/manager of a small business or as an interior decorator.

Statement of Attainment in Interior Decoration -  
Colour Consulting  
1 year part time

[www.swsi.tafensw.edu.au](http://www.swsi.tafensw.edu.au)

Interior Decoration – Colour Consulting provides you with skills, knowledge and abilities required for working and participating in Interior Decoration industries. It gives you a solid grounding in the basics of design, colour use, colour application and theories, historical colour usage in renovations, the skills and techniques applicable to renovating and remodeling interiors utilising colour selection of fixtures, furniture and finishes.

Statement of Attainment in Interior Decoration –  
Fundamentals

1 year part time

[www.swsi.tafensw.edu.au](http://www.swsi.tafensw.edu.au)

Interior Decoration – Fundamentals provides you with skills, knowledge and abilities required for working and participating in Interior Decoration industries. It gives you a solid grounding in the basics of design and material technology. You will require the skills and techniques applicable to renovating and remodeling interiors utilising creative selection of fixtures, furniture and finishes. You complete client presentation schemes.

## Design

Design

Design Fundamentals

[www.swsi.tafensw.edu.au](http://www.swsi.tafensw.edu.au)

## SUBJECTS

Colour & Design

## AWARDS

Certificate IV in Design

1 year full time

[www.swsi.tafensw.edu.au](http://www.swsi.tafensw.edu.au)

Certificate IV in Design is for people who want to develop skills and work as a Junior Design Assistant. You learn design skills through project-based work, operating individually and in teams. You will learn to

apply creative, critical, and visual judgment towards the resolution of a wide range of original solutions and ideas using a variety of materials, styles and technologies. You will develop a personal expression of contemporary design concepts to client related and individually developed and initiated projects. You will work on major design projects that can be self-initiated, and be expected to operate with entrepreneurial flair, presenting and articulating your design ideas with clarity and confidence. This course is also good underpinning knowledge for any of the design diplomas.

Certificate III in Design Fundamentals

1 year full time

[www.swsi.tafensw.edu.au](http://www.swsi.tafensw.edu.au)

Design Fundamentals is for people who want to develop fundamental skills in design. You learn about the history and theory of design and about the contemporary design industry. You will research, explore and experiment by producing drawings both by hand and computer and you will learn how to safely apply the design process to 2 and 3 dimensional works, based on a design brief. The course will cover the following areas: design research, concept development, exploration of the design process, colour theory, drawing and presentation skills and design in 2 and 3 dimensional contexts and media. This course is also good underpinning knowledge for any of the design diplomas.

Statement of Attainment in Design Foundation  
Studies

1 semester full time/part time equivalent

[www.swsi.tafensw.edu.au](http://www.swsi.tafensw.edu.au)

Design Foundation Studies is for people who want to develop underpinning skills in design. You learn design through project-based learning, operating individually and in teams, while applying creative skills and visual judgment towards the resolution of a range of original solutions and ideas using specified materials, styles and technologies. Personal expression of contemporary design concepts to individually developed and initiated projects are encouraged. Units from this course are taken from the Certificate III in Design Fundamentals.

# TAFE NSW South Western Sydney Institute

Lidcome College



**Mingwei Ma**  
Apartment Kitchen



**Mingwei Ma**  
Art Gallery



**Mingwei Ma**  
Gallery Window

# TAFE NSW South Western Sydney Institute

Lidcome College



**Ava Thomson**  
Rendered Perspective Cafe Terrace



**Nicole Martin**  
Mountain Retreat - Lounge Room



**Ava Thomson**  
Lounge Room Rendering



**Nicole Martin**  
Mountain Retreat - Kitchen

# TAFE NSW South Western Sydney Institute

Lidcome College



**Ivy Hong**  
Rosebank Entrance



**Ivy Hong**  
Apartment Entry Hall Model

# TAFE NSW South Western Sydney Institute

Lidcome College



**Alysha Downes**  
Bar Interior

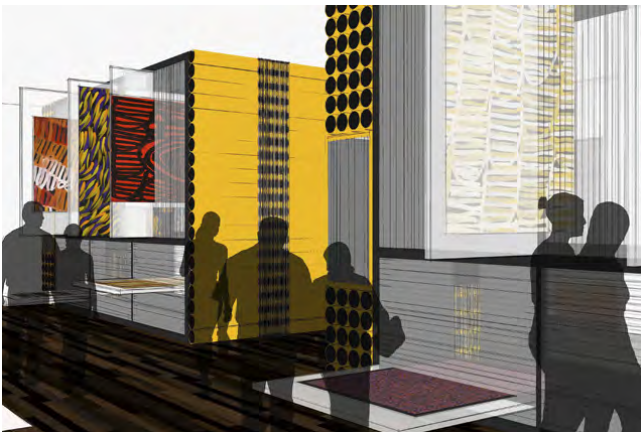

**Ivy Hong**  
Boutique Hotel Storage

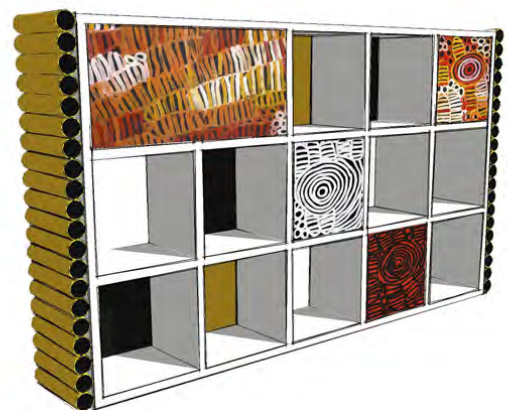

**Ivy Hong**  
Storage Unit

**TAFE NSW  
South Western Sydney Institute**

Lidcome College

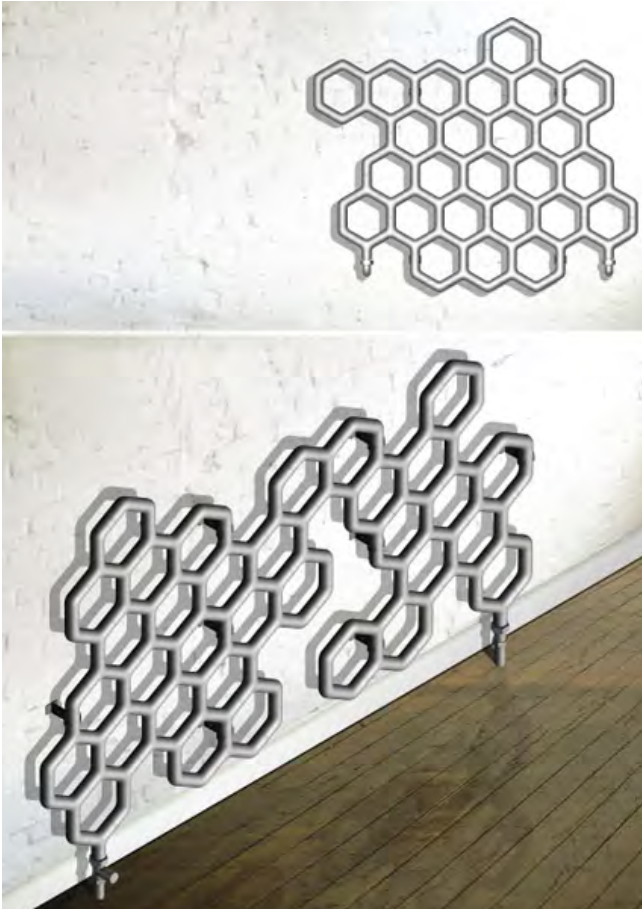

**Ben McMahon**  
Wall and Floor Cells Assembly



**Matthew Doyle**  
Small Table

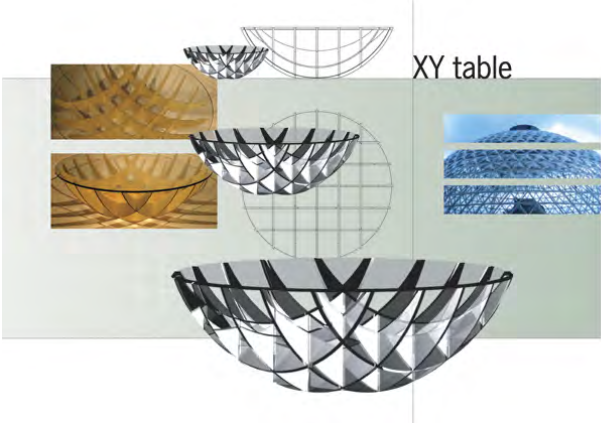

**Ben Gumley**  
XY Table



**Chi Yung Leung**  
Chuggerboard



**TAFE NSW  
South Western Sydney Institute**

Lidcome College



**Duy Trinh Dao**  
Moonwalker Stool



**Hassan Gebara**  
Stool

**TAFE NSW  
South Western Sydney Institute**

Lidcome College

DUNLOP FLEXI-STOOL  
SEN SEUDE



ENDURO

ROYLSTON HOUSE

**Stuart Graham**  
Stool



**Talia Tunstall**  
Carbide